



**SOUTHERN REGIONAL SCIENCE
ASSOCIATION**

AN INTERDISCIPLINARY ORGANIZATION, LOCATED IN THE SOUTHEASTERN
UNITED STATES, WITH MEMBERS IN APPROXIMATELY 40 STATES AND 7 COUNTRIES

50th Southern Regional Science Association Meeting

**March 23-27, 2011
New Orleans, LA**

**Royal Sonesta Hotel
Bourbon Street, French Quarter**

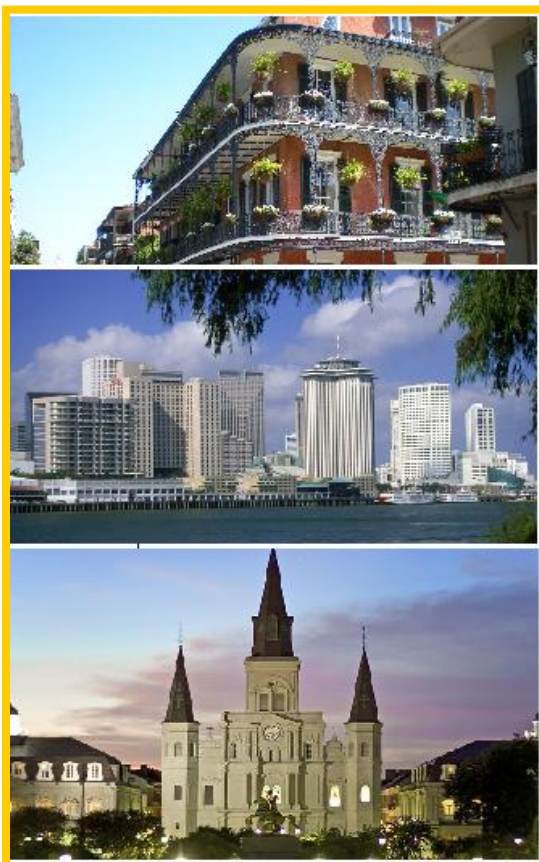

Conference Program 2011

Golden Anniversary

Welcome to SRSA's Golden Anniversary

We have an exciting program for our 2011 meeting in New Orleans. This year we convene to celebrate our half-century of annual meetings.

Please note that there may have been some changes since you last viewed the preliminary program posted on our website. Verify the timing, as well as the locations, of your papers and sessions. The author index located on pages 17-19 shows when and where you are scheduled.

The following provides a guide to the etiquette for all sessions:

- Each paper presentation is allotted twenty minutes, with an additional ten minutes of discussion.
- Discussants should prepare five minutes of remarks, allowing five minutes for questions and comments from other attendees.
- Session chairs and presenters should arrive ten minutes early for audio/visual preparation.
- We encourage each participant to bring a laptop computer to the session.
- Chairs: the order of the session is to be preserved to facilitate attendees who may be attempting to hear papers in concurrent sessions.
- Presenters and discussants should remain for the entire session.

SRSA Officers, 2010-2011

President

Randall W. Jackson–West Virginia University

President-elect and Program Chair, 2011

Douglas P. Woodward- University of South
Carolina

Immediate Past President

John E. Connaughton- University of North
Carolina, Charlotte

Co-executive Directors

John Spring, Jr., Secretary–Administrative Office of the
US Courts

Santiago Pinto, Treasurer–West Virginia University

Nominations Chair

Peter Schaeffer- West Virginia University

Honors Chair and Graduate Student Papers

Nancy White- Bucknell University

Council Members

Mark Burkey–North Carolina A&T State University

Richard Cebula- Jacksonville University

James Matt Fannin- Louisiana State University

Sarah Low- USDA Economic Research Service

Dan Rickman–Oklahoma State University

M. Rose Olfert- University of Saskatchewan

Conference Committee, 2011

Robert Brown, Bureau of Economic Analysis

David Carrier, Appalachian Regional Commission

Rick Clayton, Bureau of Labor Statistics

Kim Coffman, Minerals Management Service

Brian Cushing, West Virginia University

J. Matthew Fannin, Louisiana State University

Randall Jackson, RRI, West Virginia University

Donald J. Lacombe, West Virginia University

Michael Lahr, Rutgers University

D.M. Lambert, University of Tennessee-Knoxville

Sarah Low, USDA, Economic Research Service



**SOUTHERN REGIONAL SCIENCE
ASSOCIATION**

AN INTERDISCIPLINARY ORGANIZATION, LOCATED IN THE SOUTHEASTERN
UNITED STATES, WITH MEMBERS IN APPROXIMATELY 40 STATES AND 7 COUNTRIES

Past Presidents

- John E. Connaughton – University of North Carolina
Peter V. Schaeffer - West Virginia University
Nancy E. White - Bucknell University
David McGranahan - ERS, USDA
Cynthia Rogers - University of Oklahoma
Mark Partridge- Ohio State University
Stephen M. Smith - Pennsylvania State University
Robert Gibbs - ERS, USDA
Frank Hefner - College of Charleston
John Rees - University of North Carolina at Greensboro
Judith Stallmann - University of Missouri
Andy Bernat - BEA, US Dept. of Commerce
David Barkley - Clemson University
David Mulkey - University of Florida
Carol T. West - University of Florida
Edward J. Malecki – The Ohio State University
John R. Kort – USDA, Economic Research Service
Thomas G. Johnson - University of Missouri
Andrew M. Isserman - University of Illinois at Urbana
(deceased)
Mark S. Henry - Clemson University
David Rasmussen - Florida State University
Joseph Cartwright - U.S. Department of Defense
William Latham - University of Delaware
Hugh W. Knox - BEA, U.S. Department of Commerce
(retired)
Barry Moriarty - University of North Carolina (deceased)
James C. Hite - Clemson University
A. Ray Grimes - KPMG LLP
William J. Serow - Florida State University
Richard Olsen - Applied Business Research
John H. Cumberland - University of Maryland
Niles M. Hansen - University of Texas at Austin
Lowell D. Ashby - U.S. Dept. of Commerce (deceased)
Shirley F. Weiss - University of North Carolina (retired)
Monroe Newman - Washington, DC (Pennsylvania State
University)
William H. Miernyk - RRI, West Virginia University
(director emeritus)
James M. Stepp - Clemson University (deceased)
Alan R. Winger - FHLB of Cincinnati
William A. Schaffer - Georgia Institute of Technology
(emeritus)
Robert T. Miki - U.S. Dept. of Commerce (deceased)

Fellows

- | | |
|---------------------|-----------------------|
| Walter Isard | Edgar S. Dunn |
| William H. Miernyk | Lowell D. Ashby |
| Rutledge Vining | F. Stuart Chapin, Jr. |
| Charles L. Leven | William A. Schaffer |
| Niles M. Hansen | Brian Berry |
| James Hite | John H. Cumberland |
| Thomas Johnson | Mark S. Henry |
| Hugh Knox | Henry (Chip) Herzog |
| David Barkley | John Kort |
| Judith I. Stallmann | Andrew M. Isserman |

Sponsored by:



Regional Research Institute (RRI)
West Virginia University



PROGRAM OVERVIEW

Time	8:00	8:15	8:30	8:45	9:00	9:15	9:30	9:45	10:00	10:15	10:30	10:45	11:00	11:15	11:30	11:45	12:00	12:15	12:30	12:45	1:00	1:15	1:30	1:45	2:00	2:15	2:30	2:45	3:00	3:15	3:30	3:45	4:00	4:15	4:30	4:45	5:00	5:15	5:30	5:45	6:00	6:15																					
Thursday	Gris Gris	NE-129 Business Meeting, Board Room																												Session 1A Session 1B Session 1C			Executive Council Meeting, Bienville Gallery 6:30-8:30																														
	Choctaw																																																														
	Teche																																																														
	Belle Grove																																																														
	Oak Alley																																																														
Madewood																																																															
Friday	Gris Gris	Session 2A	Session 2B	Session 2C	Session 2D	Session 2E	Coffee Break		Session 3A	Session 3B	Session 3C	Session 3D	Session 3E	Session 3F	Awards Luncheon, Bienville Room & Parlor												Session 4A	Session 4B	Session 4C	Session 4D	Session 4E	Session 4F	Session 5A	Session 5B	Session 5C	Session 5D	Session 5E	Session 5F	Coffee Break																								
	Choctaw																																																														
	Teche																																																														
	Belle Grove																																																														
	Oak Alley																																																														
	Madewood																																																														
Saturday	Gris Gris	Session 6A	Session 6B	Session 6C	Session 6D	Session 6E	Session 6F	Coffee Break		Session 7A	Session 7B	Session 7C	Session 7D	Session 7E	Session 7F	Presidential Luncheon, Bienville Room & Parlor												Reception Beinville Gallery, Friday 6:30-8:30 pm																																			
	Choctaw																																																														
	Teche																																																														
	Belle Grove																																																														
	Oak Alley																																																														
	Madewood																																																														

50TH SRSA ANNUAL MEETING: PROGRAM SCHEDULE

Thursday, March 24th

NE-1029 Business Meeting: 8:30-12 pm, Location: Boardroom

Session 1A: 3-5 pm, Location: Gris Gris

NE-1029 Rural Development

Chair: Peter Stenberg

The Bio-Energy Activities of Spatially Dispersed Economic Actors, Peter Stenberg

Discussant: Alison Davis

What Affects Rural Wealth Creation? An Empirical Analysis of Changes in Income and Wealth in Oregon's Timber-Dependent Communities, Bruce Weber, Yong Chen*

Discussant: Mitch Renkow

Spatial Heterogeneity, Rural Property Crime and Social Capital, Steven Deller*, Mellissa Deller

Discussant: Allison Davis

Plugging Leakages in Rural Areas, Alison Davis

Discussant: Mitch Renkow

Session 1B: 3-5 pm, Location: Choctaw

Smart Growth

Chair: Michael Lahr

Walkability, Neighborhood Design, and Social Capital: Implications for Resilience and Quality of Life, John Halstead*, Shannon Rogers

Discussant: Heather Stephens

The Impact of Hudson-Bergen Light Rail on Residential Property Appreciation, Kyeongsu Kim, Michael Lahr*

Discussant: Lori Ann Dickes

Understanding the Role of Natural Amenities in Supporting Growth in the Great Lakes Region,

Heather Stephens*, Mark Partridge

Discussant: Michael Lahr

The Impact of Declining Lake Levels on Property Values: a South Carolina Hedonic Model, Lori Ann Dickes

Discussant: John Halstead

Session 1C: 3-5 pm, Location: Teche

Sustainable Regional Development I

Chair: Eric Bowen

Welcome to the Sustainable Coastal Counties: Social And Economic Resiliency to Climate Change-Induced Natural Disaster in Florida, Hyun Kim*, Kyle Woosnam, Yeol Choi

Discussant: Peter Schaeffer

Diverging Environmental Effects of Decentralized Population and Employment, Eric Bowen

Discussant: Rajendra Poudel

The Influence of Environmental Regulation on Population and Employment Change: Evidence from the Mid-Atlantic Region, Oleg Kucher, Peter Schaeffer*, Jerald Fletcher

Discussant: Eric Bowen

Reducing Poverty through Sustainable Rural Tourism: An Empirical Research, Rajendra Poudel

Discussant: Hyun Kim

**SRSA Executive Council Meeting (by invitation only)
6:30-8:30 pm, Location: Bienville Gallery**

Friday, March 25th

Beignet Breakfast: Friday 7:30-10:15 am

**Session 2A: 8-10am, Location: Gris Gris
NE-1029 Broadband and Development**

Chair: Dan Rainey

Do Higher Broadband Adoption Rates Mean Lower Tax Collections from Local Retail Sales? Implications of E-Commerce in Rural Areas of the U.S., Brian Whitacre

Discussant: Dan Otto

The Impact of Broadband on U.S. Agriculture: an Evaluation of the USDA Broadband Loan Program, Mitch Renkow*, A. Kandilov, I. Kandilov, X. Liu

Discussant: Brian Whitacre

The Potential Impact of Broadband in Rural America: the Case of the Louisiana Delta, James Barnes

Discussant: Dan Otto

Broadband, Retirees, Rural Development, and Social Security: Any Connections? Doug Morris*, Lydon

Goodridge, Alberto Manalo

Discussant: Brian Whitacre

**Session 2B: 8-10 am, Location: Bienville Gallery
Growth, Employment and Business Cycle Dynamics**

Chair: John Connaughton

Estimating and Predicting State Employment Volatility, George Hammond

Discussant: John Connaughton

Local Economic Impact of the 2008/2009 Recession, John Connaughton, Ronald Madsen
Discussant: George Hammond

A Dynamic Shift Share Analysis of Economic Growth in West Virginia, Janaranjana Herath*, Tesfa Gebremedhin, Blessing Maumbe
Discussant: Jing Wang

A Dynamic Spatial Shift-Share Analysis of Employment Change in China, Jing Wang
Discussant, Janaranjana Herath

**Session 2C: 8-10 am, Location: Teche
Methods of Applied Regional Analysis**

Chair: Matthew Fannin

Holy MOE! Don't Marginalize the Error Estimates in American Community Survey Data, Liesl Eathington
Discussant: John Lombard

The Sub-State District/Regional Council as a Geospatial Unit of Analytical Geography for the United States, Thomas Christoffel
Discussant: Matthew Fannin

Comparing Functional Regions Using Two Alternative Data Sources: US Census Bureau LED Commuting Data Versus IMPLAN Trade Data, Raghavendra Kongari, Arun Adhikari, Matthew Fannin*
Discussant: Thomas Christoffel

Defining and Measuring Modeling and Simulation Activity in the Southeast, John Lombard
Discussant: Liesl Eathington

**Session 2D: 8-10 am, Location: Belle Grove
Spatial Econometrics and Modeling**

Chair: James LeSage

The Biggest Myth in Spatial Econometrics, James LeSage
Discussant: Paulo Guimaraes

Accounting for Neighboring Effects in Measures of Spatial Concentration, Paulo Guimaraes
Discussant: Giuseppe Arbia

Some Results on the MAUP in Spatial Interaction Gravity Models, Giuseppe Arbia
Discussant: Gianfranco Piras

On The Parameter Space in Higher Order Spatial Econometric Models, Gianfranco Piras*, Donald Lacombe, Paul Elhorst
Discussant: James LeSage

**Session 2E: 8-10 am, Location: Oak Alley
Public Finance and Policy**

Chair: Eric Scorsone

Spatial Dependence in Tobacco Excise Taxation: the Impact of Special Interest Groups, Adam Hoffer
Discussant: Santiago Pinto

The Economic and Fiscal Implications of Shrinking City Policies, Eric Scorsone
Discussant: Adam Hoffer

Goods Allocation by Queuing and the Occurrence of Violence: a Probabilistic Analysis, Amitrajeet Batabyal
Discussant: Eric Scorsone

Domestic Firms, Multinational Firms, and the Corporate Profit Tax System, Santiago Pinto
Discussant: Amitrajeet Batabyal

**Session 3A: 10:15-12:15 pm, Location: Gris Gris
Labor Market Earnings and Migration**
Chair: Peter Schaeffer

The Migratory Response to Racial Wage Disparity, Craig Kerr*, Randall Walsh
Discussant: Dwight Adamson

The Economic Benefit of Migration: a Case Study of Hispanic Outmigrants from the Southern California Region, Jiyoun Park*, Seongdo Yun, Simon Choi
Discussant: Pat O'Brien

Low Skilled Household Migration and Incomplete Wage Compensation, Nancy White*, Thomas Knapp, David Clark, William Herrin
Discussant: Robert Dunn

**Session 3B: 10:15-12:15 pm, Location: Bienville
Gallery
Poverty and Appalachian Development**
Chair: Nyakundi Michieka

Poverty and Place across the United States: Do County Governments Matter to the Distribution of Economic Disparities, P. Wilner Jeanty, Linda Lobao, Mark Partridge, David Kraybill
Discussant: Nyakundi Michieka

Bayesian Approach to Model Selection: a Spatial Econometric Analysis of SNAP Participation Rates In Appalachia, David Lacombe, Nyakundi Michieka*, Tesfa Gebremedhin
Discussant: Saima Bashir

A Spatial Analysis of Poverty and Income Inequality in the Appalachian Region, Sudiksha Joshi, Tesfa Gebremedhin, Saima Bashir*
Discussant: Chali Nondo

Spatial Analysis of the Interactions between Economic Growth and Environmental Regulations: Evidence from the Appalachia Region, Chali Nondo*, Peter Schaeffer, Jerald J. Fletcher
Discussant: P. Wilner Jeanty

Session 3C: 10:15-12:15 pm, Location: Teche Innovation, Technology, and Economic Performance
Chair: William Latham

Creativity and Mobility: Evidence from Patenting Data, William Latham*, Dmitry Volodin, Christian Le Bas
Discussant: Dan Rickman

Innovative Entrepreneurship and Economic Growth in Lagging regions, Heather Stephens*, Alessandra Faggian, Mark Partridge
Discussant: Ranjana Srevatsan

Geographic Determinants of High-Tech Employment Growth in U.S. Counties, Belal Fallah, Mark Partridge, Dan Rickman*
Discussant: William Latham

The Role of University Industry Collaboration in Regional Economic Development, Ranjan Srevatsan
Discussant: Heather Stephens

Awards Luncheon

Friday 12:30-2 pm: Bienville Room & Parlor

Award of SRSA Fellow Plaque: Brian Cushing

SRSA Fellow's Address by Brian Cushing,
"Advancement of Knowledge: a Journey through Space and Time"

Session 4A: 2:15-4:30 pm, Location: Gris Gris Resilience in the Gulf Region
Chair: Shaoming Cheng

The Short- and Long-Term Negative Economic and Fiscal Impacts of the Gulf of Mexico Drilling Moratoria, Bernard Weinstein
Discussant: Rebekka Dudensing

Preliminary Macroeconomic and Fiscal Impacts of the 2010 Deepwater Horizon Oil Spill on Alabama, Samuel Addy, Ahmad Ijaz*, Kilungu Nzaku
Discussant: Bernard Weinstein

Rural Resilience: Drivers of Housing Recovery Following Hurricane Katrina, Shaoming Cheng*, Emel Ganapati, Sukumar Ganapati
Discussant: Matt Fannin

Municipal versus County Government Financial Health following a Natural Disaster: Does Size Matter? Evidence from Louisiana following the 2005 Hurricane Season, Matthew Fannin*, Jeanne St. Romain, Laura Falgoust, Joshua Detre
Discussant: Shaoming Cheng

Post-Ike Economic Resilience along the Texas Coast, Rebekka Dudensing, Ruoxi Lu*
Discussant: Ahmad Ijaz

**Session 4B: 2:15-4:15 pm, Location: Bienville Gallery
Real Estate and Housing**
Chair: Joseph Von Nessen

Power Laws and Bubbles in Real Estate Prices, Calvin Blackwell
Discussant: Clifford Lipscomb

Proposed Biomass Facility Impacts on Prospective Property Values, Clifford Lipscomb
Discussant: Calvin Blackwell

The Influence of Growth Restrictions on Housing Prices in Mt. Pleasant, S.C., Joseph Von Nessen*, Doug Woodward, Paulo Guimaraes
Discussant: Michael Shiroya

A Finite Mixture Approach for Household Residential Choices, Michael Shiroya*, Michael Farmer, Eric Belaso
Discussant: Joey Von Nessen

**Session 4C: 2:15-4:15 pm, Location: Teche
Sustainable Regional Development II**
Chair: Davina Bird

Energy Development: Exploring Energy Rich Regions Within The Current Global Energy System, Hojdat Ghadimi, Davina Bird*
Discussant: ChangKeun Park

Measuring Inter-County Spillover Economic Effects of Greenhouse Gas (GHG) Emission in Southern California Region, ChangKeun Park*, JiYoung Park, Simon Choi
Discussant: Davina Bird

Who Generates Hazardous Wastes in the United States? Attribution of Consumer and Producer Responsibility, Christa Jensen
Discussant: Mark Burkey

Explaining Attitudes on the Ogallala: The Importance of Space-Time, Mark Burkey
Discussant: Christa Jensen

**Session 4D: 2:15-4:15 pm, Location: Belle Grove
Entrepreneurship and Technology Development**
Chair: Paul Coomes

A Schumpeterian Model of Entrepreneurship, Innovation, and Regional Economic Growth, Amitrajeet Batabyal
Discussant: Maria Figueroa

The Rate Of Proprietorship among Metropolitan Areas: The Impact of Institutions, Local Economic Environment and Capital Resources, Paul Coomes*, Stephan Gohmann, Jose Fernandez
Discussant: Amitrajeet Batabyal

A Simultaneous Analysis of the Link between New Firm Formation and Economic Development in the Northeast Region of the United States, Saima Bashir*, Tesfa Gebremedhin
Discussant: Paul Coomes

Necessity and Opportunity Entrepreneurship in America: a Study on Gender, Rurality, and Unemployment, Maria Figueroa
Discussant: Saima Bashir

Session 4E: 2:15-4:15 pm, Location: Oak Alley
Input-Output and Impact Analysis
Chair: William Schaffer

Comparing Input-Output Tables of Different Economies: a New Application for Decomposition Techniques? Michael Lahr*, Ling Yang
Discussant: David Swenson

The Regional Economic Development Potential and Constraints to Local Foods Development in the Midwest, David Swenson
Discussant: Michael Lahr

Comparing the Input Coefficients and Total Effects of Biofuels Production Using Survey and Non-survey Data, James Rossi
Discussant: William Schaffer

An Interregional Economic-Base Model of Canada, 2004, William Schaffer*, John Jozsa
Discussant: James Rossi

Session 4F: 2:15-4:15 pm, Location: Madewood NE-1029 State and Local Public Finance
Chair: Mark Skidmore

Margins of Local Governmental Leadership: the Case of Local Option Sales Taxes, Cynthia Rogers*, Gregory Burge
Discussant: Judith Stallmann

The Impact of Tax and Expenditure Limitations on City Credit Ratings, Steven Deller, Judith Stallmann*, Lindsay Amiel, Craig Maher
Discussant: Mark Skidmore

The Political Economy of State Ethanol Subsidy Adoption, Mark Skidmore*, James Alm, Chad Cotti

Discussant: Judith Stallmann

Determinants of Debt Levels by Rural Cities in Iowa, Dan Otto, Mike Hudak

Discussant: Mark Skidmore

Coffee Break: Friday 4:15-4:30 pm

**Session 5A: 4:30-6:15 pm, Location: Gris Gris
Understanding Migration for Declining Regions**

Chair: Nancy White

*Macro Determinants of Labor Migration in CEE
Transitional Economies*, Denise Francois

Discussant: Masood Gheasi

*The Common Threads of States with Net Out-Migration,
Shahdad Naghshpour*, Denise Francois

Discussant: Thomas Knapp

*Who Moves to Inefficient Government Units? The Other
Side of Voting With Your Feet*, George Grassmueck

Discussant: Maryam Naghsh Nejad

**Session 5B: 4:30-6:15 pm, Location: Bienville Gallery
New Developments in Federal Data: Bureau of
Economic Analysis**

Chair: Carol Robbins

Regional Price Parities 2005-2009, Bettina Aten, Troy Martin*

Discussant: Carol Robbins

*Converting States Published Statistics from SIC to NAICS
Basis: Methods and Preliminary Estimates*,

Christian Awuku-Budu

Discussant: Troy Martin

*Uses and Misuses of RIMS II for Economic Impact Analysis:
Suggestions for Practitioners*, Zoe Ambargis*, Rebecca Bess

Discussant: William Latham

Reception

Friday, 6:30-8:30 pm

Location: Bienville Gallery and Courtyard

Saturday, March 26

**Session 6A: 8-10 am, Location: Gris Gris
Topics: U.S. State and Local Economic Development**

Chair: Brian Whitacre

*Rural Broadband Availability and Adoption during the
2000s: a Case Study from Oklahoma*, Brian Whitacre

Discussant: Alan Barefield

An Evaluation of a Public Water System Education And Technical Assistance Program In Mississippi, Jason R. Barrett, Alan Barefield*
Discussant: P. Wilner Jeanty

Effects of Local Government Land Use Policies on Crop Diversity: a Two-Stage Multinomial Logit Approach, P. Wilner Jeanty, Mark Partridge, Casey Hoy, Linda Lobao, David Kraybill
Discussant: Brian Whitacre

Session 6B: 8-10 am, Location: Bienville Gallery
International Migration

Chair: Robert Dunn

Why is there a High Female Brain Drain in Developing Countries? Maryam Naghsh Nejad
Discussant: Leslie Dunn

Economic Impact of NAFTA on the Mexican Population and Subsequent Migratory Incentives, Pat O'Brien
Discussant: Craig Kerr

Migrants and International Economic Linkages: a Meta-Overview, Masood Gheasi, Peter Nijkamp *, Piet Rietveld
Discussant: Peter Schaeffer

Session 6C: 8-10 am, Location: Teche
Health and Regional Development

Chair: David Hughes

Living 'Large' in the Wide Open Space: the Link between Remoteness and Obesity, Mouhcine Guettabi*, Abdul Munasib
Discussant: Cristian Nedelea

Food Access in the Palmetto State: Identifying Potential Food Desert/Food Imbalance Areas in South Carolina, Caroline Swiger, Kathryn Boys, Julia Sharp, David Hughes*
Discussant: Mouhcine Guettabi

Can Twenty Minutes on the Treadmill Save You From Bankruptcy? The Impact of Obesity on Consumer Bankruptcy, Mouhcine Guettabi*, Abdul Munasib
Discussant: David Hughes

Efficiency Differences between Critical Access Hospitals and Prospectively Paid Rural Hospitals: Two-Stage Approach vs. Stochastic Frontier Analysis, Cristian Nedelea*, Matthew Fannin
Discussant: Mouhcine Guettabi

Session 6E: 8-10 am, Location: Oak Alley
Human Capital and Labor Markets

Chair: Kilungu Nzaku

Human Capital Drift up the Urban Hierarchy, Margaret Olfert

Discussant: Maribel Mojica

Examining the Impact of Human Capital on Employment and Income in Mississippi, Maribel Mojica

Discussant: Kilungu Nzaku

Job Satisfaction and Underemployment in Alabama, Samuel Addy, Kilungu Nzaku*, Ahmad Ijaz

Discussant: Amanda Weinstein

Working Women and Metropolitan Productivity, Amanda Weinstein

Discussant: Margaret Olfert

**Session 6F: 8-10 am, Location: Madewood
Globalization and Regional Development**

Chair: Shahdad Naghshpour

Globalization Before and After the 2008 Recession: Did Recession Change Globalization Ranking, Shahdad Naghshpour

Discussant: Christian Awuku-Budi

Regional Differential Impacts of International Trade: Evidence from the United States, Christian Awuku-Budi

Discussant: Alejandro Davila

Trade Liberalization, Structure of Final Demand and Economic Performance Jalisco State. Mexico: 2003-2010, Alejandro Davila*, Miriam Valdes Ibarra*

Discussant: Christian Awuku-Budi

Coffee Break: Saturday 10-10:15 am

**Session 7A: 10:15-12:15 pm, Location: Gris Gris
Causes and Consequences of Migration**

Chair: Brian Cushing

Domestic Migration and Residential Electricity Consumption, Caitlin Brown*, Robert Dunn

Discussant: Nancy White

Factors Influencing the Metropolitan and Nonmetropolitan Migration Decision, Dwight Adamson*

Discussant: Shahdad Naghshpour

Domestic Migration Response to Nuclear Disaster, Leslie Dunn*, Robert Dunn*

Discussant: Jiyoung Park

**Session 7B: 10:15-12:15 pm, Location: Bienville
Gallery**

Incentives, Regulation and Regional Development

Chair: Doug Woodward

Migration of the Auto Industry in the South, Doug Woodward

Discussant: Frank Hefner

Paralyzed State Technology Investments and the Impact on State Small Business Growth, Lori Ann Dickes

Discussant: Carlianne Patrick

Glamorous Incentives: the Cost and Benefits of Attracting Hollywood to South Carolina, Frank Hefner

Discussant: Doug Woodward

The Economic Development Incentives Game: an Imperfect Information, Heterogeneous Communities Approach, Carlianne Patrick

Discussant: Lori Ann Dickes

Session 7C: 10:15-12:15 pm, Location: Teche Regional Development in Developing Countries

Chair: Chali Nondo

Institutional Quality and FDI in Sub-Saharan Africa, Mulugeta Kahsai

Discussant: Adam Peillilo

Telecommunications Investment and Economic Growth, Chali Nondo*, Mulugeta Kahsai

Discussant: Adam Peillilo

Conflict and Development: Evidence from the Democratic Republic of the Congo, Adam Peillilo

Discussant: Chali Nondo

Presidential Luncheon and SRSA Business Meeting

Friday 12:30-2 pm: Bienville Room & Parlor

Randall Jackson, West Virginia University

SRSA President's Address: "Knowns, Unknowns, and Impacts"

Participants Index

Name (Alphabetical by Last Name)	E-Mail Address	Author	Discussant	Chair
Adamson, Dwight	bill.adamson@sdsta.te.edu	7A	3A	
Ambargis, Zoe	zoe.ambargis@bea.gov	5B		
Arbia, Giuseppe	arbia@unich.it	2D	2D	
Aten, Bettina	bettina.aten@bea.gov	5B		
Awuku-Budu, Christian	chris.budu@gmail.com	5B 6F	6F	
Barefield, Alan	alanb@ext.msstate.edu	6A	6A	
Barnes, James	jbarnes@agcenter.lsu.edu	2A		
Bashir, Saima	saima.bashir@mail.wvu.edu	3B 4D	3B	
Batabyal, Amitrajeet	aabgsh@rit.edu	2E 4D	2E 4D	
Bird, Davina	davina.bird@mail.wvu.edu	4C	4C	4C
Blackwell, Calvin	blackwellc@cofc.edu	4B	4B	
Bowen, Eric	eric.bowen@mail.wvu.edu	1C	1C	1C
Brown, Caitlin	browncm@washjeff.edu	7A		
Burkey, Mark	burkeym@ncat.edu	4C	4C	
Chen, Yong	yong.chen@oregonstate.edu	1A		
Cheng, Shaoming	scheng@fiu.edu	4A	4A	4A
Christoffel, Tom	Tom.Christoffel@gmail.com	2C	2C	
Clark, David	david.clark@marquette.edu	3A		
Connaughton, John	jec@uncc.edu	2B	2B	2B
Coomes, Paul	paul.coomes@louisville.edu	4D	4D	4D
Cushing, Brian	brian.cushing@mail.wvu.edu	7A		
Davila, Alejandro	alejandro.davila@uadec.edu.mx	6F	6F	
Davis, Alison	alison.davis@uky.edu	1A	1A	
Deller, Steven	scdeller@wisc.edu	1A 4F		
Dickes, Lori Ann	ldickes@clmson.edu	1B 7B	1B 7B	
Dudensing, Rebekka	rmdudensing@tamu.edu	4A	4A	
Dunn, Leslie	ldunn@washjeff.edu	7A	6B	
Dunn, Robert	rdunn@washjeff.edu	7A	3A	6B
Eathington, Liesl	leathing@iastate.edu	2C	2C	
Fannin, Matthew	mfannin@agcenter.lsu.edu	2A 4A	2A 6B	2A
Figueroa, Maria	maf3nc@mail.mizzou.edu	4D	4D	
Francois- Seeney, Denise	francoisdenise@yahoo.com	5A		
Grassmueck, Georg	grassmue@lycoming.edu	5A		
Guettabi, Mouhcine	mouhcine.guettabi10@okstate.edu	6C	6C	
Guimaraes, Paulo	guimaraes@moore.sc.edu	2D	2D	
Halstead, John	johnh@christa.unh.edu	1B	1B	

Hammond, George	ghammond@wvu.edu	2B	2B	
Herath, Janaranjana	samanjanaranjana@yahoo.com	2B	2B	
Hoffer, Adam	adam.hoffer@mail.wvu.edu	2E	2E	
Hughes, David	dhughe3@clermson.edu	6C	6C	6C
Ibarra, Miriam Valdes	miriam.valdes@gmail.com	6F		
Jeanty, Wilner P.	jeanty.1@osu.edu	3B 6A	3B 6A	
Jensen, Christa	christa.jensen@mail.wvu.edu	4C	4C	
Kahsai, Mulugeta	Mulugeta.Kahsai@mail.wvu.edu	7C	7C	
Kerr, Craig	econkerr@gmail.com	3A	6B	
Kim, Hyun	hkim9129@tamu.edu	1C	1C	
Knapp, Thomas	kzu@psu.edu	3A	5A	
Lahr, Michael	lahr@rutgers.edu	1B 4E	1B 4E	1B
Latham, William	latham@udel.edu	3C	3C 5B	3C
Lesage, James	james.lesage@txstate.edu	2D	2D	2D
Lipscomb, Clifford	cliff@greenfieldadvisors.com	4B	4B	
Lombard, John	jlombard@odu.edu	2C	2C	
Lu, Ruoxi	ruoxi.lu@tamu.edu	4A		
Martin, Troy	troy.martin@bea.gov	5B	5B	
Michieka, Nyakundi	nyakundi.michieka@mail.wvu.edu	3B	3B	3B
Mojica, Maribel	mnojica@alcorn.edu	6E	6E	
Morris, Doug	dr.doug@unh.edu	2A		
Naghsh Nejad, Maryam	maryam.naghshn@mail.wvu.edu	6B	5A	
Naghshpour, Shahdad	s.naghshpour@usm.edu	6F	7A	6F
Nedelea, Cristian	inedell@lsu.edu	6C	6C	
Nijkamp, Peter	pnijkamp@feweb.vu.nl	6B		
Nondo, Chali	nondo.chali@gmail.com	3B 7C	3B 7C	7C
Nzaku, Kilungu	kznzaku@cba.ua.edu	6E	6E	6E
O'Brien, Pat	PO'Brien@jbu.edu	6B	3A	
Olfert, Margaret	rose.olfert@usask.ca	6E	6E	
Otto, Dan	dmotto@iastate.edu	4F	2A	
Park, Changkeun	chpark@uga.edu	4C	4C	
Park, Jiyoung	jp292@buffalo.edu	3A	7A	
Patrick, Carlianne	patrick.170@buckeyemail.osu.edu	7B	7B	
Peillilo, Adam	Adam.Pellillo@mail.wvu.edu	7C	7C	
Pinto, Santiago	smpinto@mail.wvu.edu	2E	2E	
Piras, Gianfranco	Gianfranco.Piras@mail.wvu.edu	2D	2D	
Poudel, Rajendra	rpoudel@mail.wvu.edu	1C 7C	1C 7C	
Rainey, Dan	rainey@uark.edu		2A	
Renkow, Mitch	renkow@ncsu.edu	2A	1A	
Rickman, Dan	dan.rickman@okstate.edu	3C	3C	

Robbins, Carol	Carol.Robbins@bea.gov	5B	5B	
Rogers, Cynthia	crogers@ou.edu	4F		
Schaeffer, Peter	peter.schaeffer@mail.wvu.edu	1C	1C 6B	3A
Schaffer, William	william.schaffer@econ.gatech.edu	4E	4E	4E
Scorsone, Eric	scorsone@msu.edu	2E	2E	2E
Shiroya, Michael	m.shiroya@ttu.edu	4B	4B	
Skidmore, Mark	mskidmor@msu.edu	4F	4F	
Srevatsan, Ranjan	ranjanasrevatsan@hotmail.com	3C	3C	
Stallmann, Judith	stallmannj@missouri.edu	4F	4F	
Stenberg, Peter	stenberg@ers.usda.gov	1A		1A
Stephens, Heather	stephens.177@osu.edu	1B 3C	1B 3C	
Swenson, David	dswenson@iastate.edu	4E	4E	
Von Nessen, Joey	Joey.VonNessen@moore.sc.edu	4B	4B	4B
Wang, Jing	jing.wang@okstate.edu	2B	2B	
Weinstein, Amanda	weinstein.74@osu.edu	6E	6E	
Weinstein, Bernard	bweinstein@cox.smu.edu	4A	4A	
Whitacre, Brian	brian.whitacre@okstate.edu	2A 6A	2A 6A	
White, Nancy	nwhite@bucknell.edu	3A	7A	5B
Woodward, Doug	woodward@moore.sc.edu	7B	7B	

Royal Sonesta Hotel Layout

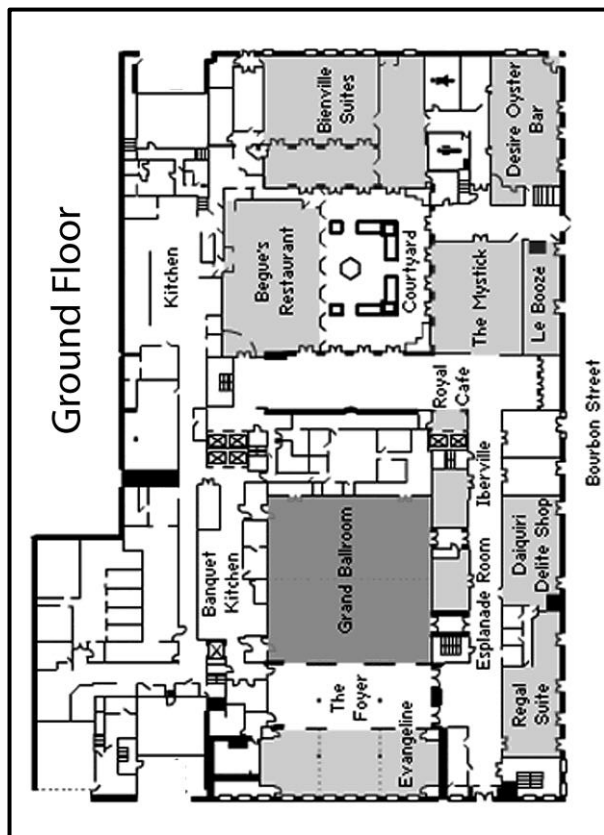
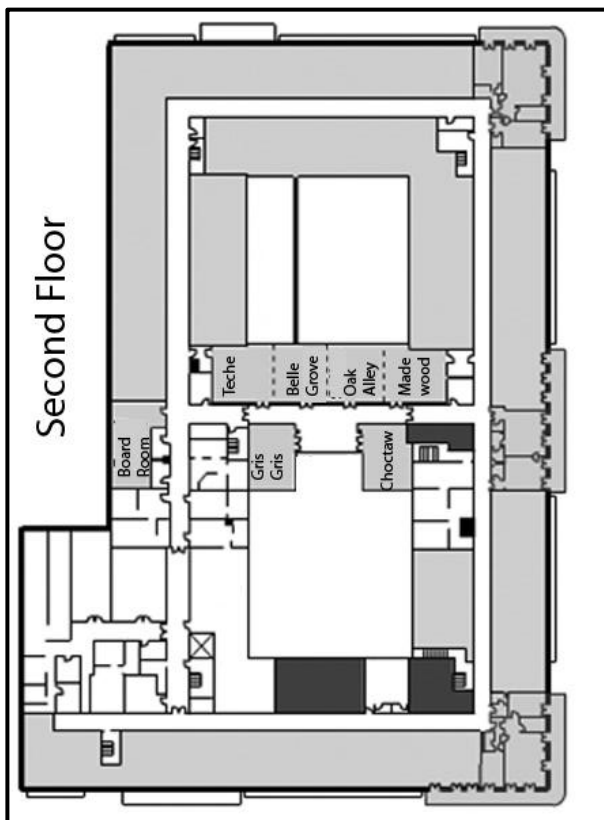

886 Chestnut Ridge Road PO Box 6825 Morgantown, WV 26506-6825 Tel: 304-293-2897

The Regional Research Institute at West Virginia University



The Regional Research Institute at West Virginia University conducts and promotes interdisciplinary research on the economic and social development of lagging regions. As a center of regional research excellence for nearly five decades, the RRI is an internationally recognized center for the advancement of regional science.

Our research focuses on theories and history of regional development, methods for studying regions, and policies for stimulating their development. We seek to advance our understanding of socioeconomic processes and our ability to explain regional differences in rates of growth and levels of development. RRI activities are both national and international in scope. Our research interests span the globe, with a special focus on our own Appalachian region.

The Institute is committed to scholarship at its highest levels. We have a core of regional science research faculty within the Institute, dozens of Faculty Research Associates across campus representing twelve departments and five colleges, an extensive network of scholars throughout the United States and abroad, and an outstanding group of graduate students. Our goals are to create learning opportunities and to provide research support for those engaged in regional research. We bring together scholars from across campus and around the world to create an intellectually rich environment for the conduct of regional research, and we sponsor seminars, workshops, and conferences, providing a forum for exchanging ideas and discussing regional development research and issues.

The Web Book of Regional Science, which can be accessed via the Institute's website, is a valuable learning resource used worldwide by teachers and professionals alike. Providing both instructional and research reference materials, the RRI website ranks highly on all search engines, which translates to exceedingly wide dissemination of research results.

With two of the leading experts in spatial econometrics on our staff, we welcome and encourage inter-institutional research collaborations. We invite you to browse our website and to contact us to explore the possibilities of becoming a member of our regional research community.

West Virginia University is an Equal Opportunity/Affirmative Action Institution. West Virginia University is governed by the West Virginia University Board of Governors and the West Virginia Higher Education Policy Commission.

Historical Cost of Living Data Available from C2ER

The Council for Community and Economic Research compiles price data on more than 60 goods and services from over 300 urban areas. Published since 1968, the ACCRA Cost of Living Index is the most consistent source of city-to-city comparisons of key consumer costs available anywhere. Usually available in quarterly publications, these data are now available to academics and researchers in one historical dataset representing quarterly data from 1990.

Included are:

- Data analysis for cross sectional, time series, or panel data
- Data available for approximately 300 metropolitan statistical areas
- Data available on a quarterly basis since 1990
- Data organized in six component categories (food, housing, utilities, transportation, health care, and miscellaneous goods and services)
- Data available as quarterly average prices and indexed to a national average
- Available in Excel format
- Participating areas updated based on 2008 metro definitions from the Census Bureau
- Methodology is recognized by the Census Bureau, Bureau of Labor Statistics, President's Council of Economic Advisors, and Brookings Institution
- Sited by national media such as CNN, Forbes, MSN Money, Wall Street Journal

Academic researchers and their institutions can have this dataset for only \$750. This is a substantial savings over both the individual prices for our quarterly data and our normal price for the historical dataset.

For more information, please visit our website (www.coli.org) or call Dean Frutiger at 703-522-4980 (ext. 1021) to take advantage of this offer or to see sample data.

Louisiana Center for Rural Initiatives

The Louisiana Center for Rural Initiatives (LCRI) is a collaboration between the LSU and Southern University Agricultural Centers to provide research-based educational programs to create economic opportunities for rural communities in Louisiana. The mission of the LCRI is to improve the socioeconomic well-being in rural communities by: (1) providing leadership that assures focused, applied rural development research and community outreach; (2) increasing awareness and understanding of rural development conditions, issues, strategies and policies in Louisiana, and (3) providing rural community stakeholders and policy makers with information necessary for public-policy decision making.

LCRI faculty conduct rural development research and extension activities in Regional Economic and Community Analysis, Broadband Technology Education, Entrepreneurship, Leadership and Civic Engagement, and Health Care Delivery.

James Barnes, Ph.D.
*Associate Professor &
LCRI Extension Director*
LSU AgCenter
Ph: (318) 428-3571
E-mail:
jbarnes@agcenter.lsu.edu

Matthew Fannin, Ph.D.
*Associate Professor &
LCRI Research Director*
LSU AgCenter
Ph: (225) 578-0346
E-mail:
mfannin@agcenter.lsu.edu

LCRI is academically housed in the Department of Agricultural Economics and Agribusiness at the Louisiana State University Agricultural Center. LCRI's satellite outreach centers include the Delta Rural Development Center (www.lsuagcenter.com/drc) located in Oak Grove, LA, and the Southwest Center for Rural Initiatives (www.suswcenter.com) located in Opelousas, LA.





SCRA is a global leader in applied research and commercialization services with its headquarters in South Carolina. SCRA has a dual mission:

- **Delivering technology solutions to complex challenges** - SCRA affiliate Advanced Technology International (ATI) leads applied research collaborations that develop technologies to improve the mission effectiveness of Federal agencies and the business execution of Corporations. Learn more at www.ati.org.
- **Advancing the Knowledge Economy** - SCRA affiliate SC Launch is an economic development program that helps early-stage companies commercialize innovations and create jobs. Learn more at www.sclaunch.org.

In support of both missions, SCRA builds and manages research facilities that include wet labs, secure rooms for sensitive work and advanced, high-tech manufacturing shops.