

---

## **56<sup>TH</sup> MEETING OF THE SOUTHERN REGIONAL SCIENCE ASSOCIATION**

---

# **Conference Program 2017**

**March 30 – April 1, 2017  
Memphis, TN  
Marriott Memphis East**

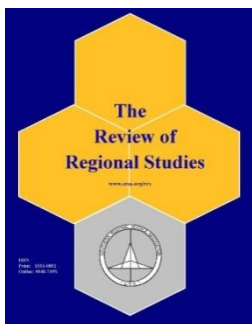

**Southern Regional Science Association**

AN INTERDISCIPLINARY ORGANIZATION, LOCATED IN THE SOUTHEASTERN UNITED STATES,  
WITH MEMBERS IN APPROXIMATELY 40 STATES AND 7 COUNTRIES.

**Sponsored By:**

**IMPLAN**



**West Virginia University**

COLLEGE OF BUSINESS AND ECONOMICS

**Bureau of Business and Economic Research**

---



**Sponsored By:**



Marriott Memphis East Floor Plan

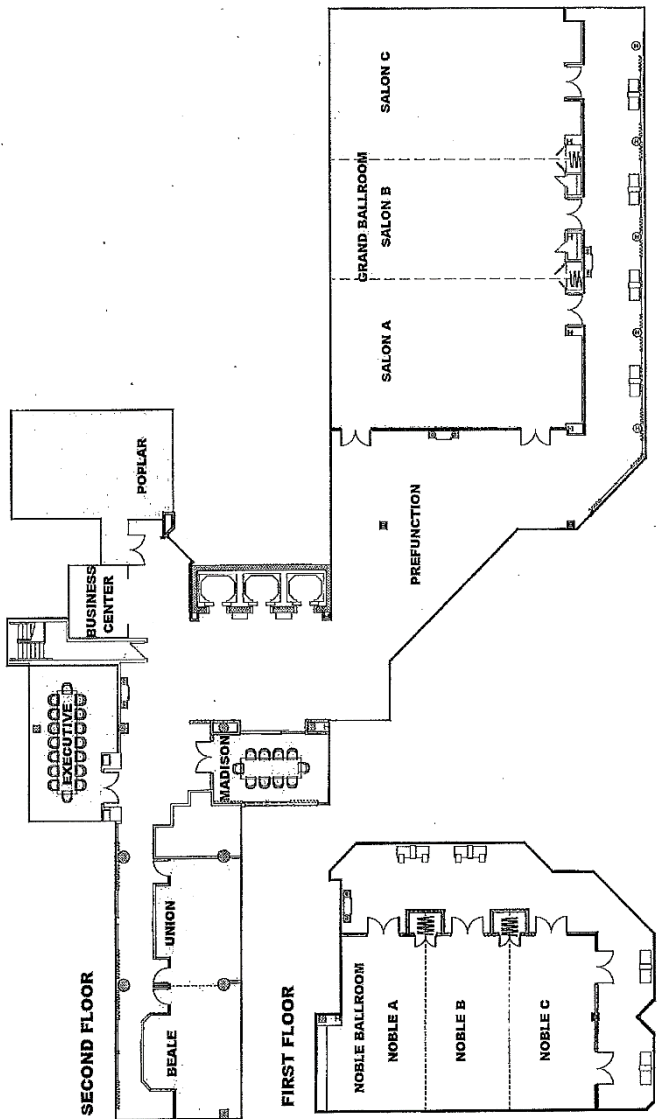

# Announcements

Visit the exhibit tables of our sponsors in the Noble Prefunction room

## Sponsor of Reception

Thank you to our **Gold** sponsor who provided financial support for the SRSA Reception and Undergraduate Poster Session:

- IMPLAN

## Sponsors of Refreshment Breaks

Thank you to our sponsors who provided financial support for the refreshment breaks:

### **Silver** Sponsors

- Bureau of Business and Economic Research, West Virginia University
- Regional Research Institute, West Virginia University

## Other Sponsors

### **Bronze** Sponsors

- Council for Community and Economic Research/C2ER
- Economic Research Service, United States Department of Agriculture
- Jacksonville University
- Economic Impact Analysis Program, University of Florida

## Register for SRSA News

If you have not done so already, please go to

[www.SRSA.org](http://www.SRSA.org)

and register for the SRSA News e-mail list.

## **SRSA Officers, 2016-2017**

### **President**

Brian Cushing, West Virginia University

### **President-Elect and Program Chair**

Richard Cebula, Jacksonville University

### **Immediate Past President**

Santiago Pinto, Federal Reserve Bank of Richmond

### **Co-Executive Directors**

John Sporing, Jr., BEA, US Department of Commerce  
(retired)

Heather Stephens, Treasurer, West Virginia University

### **NARSC Councilor**

Thomas Knapp, Penn State Wilkes-Barre

### **Nominations Chair**

Steven Deller, University of Wisconsin-Madison

### **Honors Chair and Graduate Student Papers**

Michael Lahr, Rutgers, The State University of New Jersey

### **Council Members**

Dayton Lambert, University of Tennessee

Frank Goetzke, University of Louisville

Don Lacombe, Texas Tech University

John Winters, Oklahoma State University

Tony Grubescic, Oregon State University

Carlianne Patrick, Georgia State University

### **Editors, *The Review of Regional Studies***

Amanda Ross, University of Alabama – Managing Editor

Mark Burkey, North Carolina A&T State University –  
Technical Editor

Michael Lahr, Rutgers, The State University of New Jersey  
– Advisory Editor

### **Conference Committee 2017**

Richard Cebula (Chair), Jacksonville University

Brian Cushing, West Virginia University

John Connaughton, University of North Carolina-Charlotte

Christa Court, University of Florida

Rogina Gale, Jacksonville University

John Sporing, Jr., BEA, US Dept. of Commerce (retired)

Judith Stallmann, University of Missouri

Heather Stephens, West Virginia University

Daniel Sutter, Troy University

## Past Presidents

Santiago Pinto, Federal Reserve Bank of Richmond  
Steven Deller - University of Wisconsin-Madison  
Michael L. Lahr - Rutgers, The State University of New Jersey  
Dan Rickman - Oklahoma State University  
Douglas P. Woodward - University of South Carolina, Columbia  
Randall W. Jackson - RRI, West Virginia University  
John E. Connaughton - University of North Carolina, Charlotte  
Peter V. Schaeffer - West Virginia University  
Nancy E. White - Bucknell University  
David McGranahan - ERS, USDA  
Cynthia Rogers - University of Oklahoma  
Mark Partridge - The Ohio State University  
Stephen M. Smith - Pennsylvania State University  
Robert Gibbs - ERS, USDA  
Frank Hefner - College of Charleston  
John Rees - University of North Carolina, Greensboro  
Judith Stallmann - University of Missouri  
Andy Bernat - BEA, US Dept. of Commerce  
David Barkley - Clemson University  
David Mulkey - University of Florida  
Carol T. West - University of Florida  
Edward J. Malecki - The Ohio State University  
John R. Kort - BEA, US Dept. of Commerce  
Thomas G. Johnson - University of Missouri  
Andrew M. Isserman - University of Illinois, Urbana-Champaign  
Mark S. Henry - Clemson University  
David Rasmussen - Florida State University  
Joseph Cartwright - US Dept. of Defense  
William Latham - University of Delaware  
Hugh W. Knox - BEA, US Dept. of Commerce  
Barry Moriarty - University of North Carolina  
James C. Hite - Clemson University  
A. Ray Grimes - KPMG LLP  
William J. Serow - Florida State University  
Richard Olsen - Applied Business Research  
John H. Cumberland - University of Maryland  
Niles M. Hansen - University of Texas, Austin  
Lowell D. Ashby - US Dept. of Commerce  
Shirley F. Weiss - University of North Carolina  
Monroe Newman - Pennsylvania State University  
William H. Miernyk - RRI, West Virginia University  
James M. Stepp - Clemson University  
Alan R. Winger - FHLB of Cincinnati  
William A. Schaffer - Georgia Institute of Technology  
Robert T. Miki - US Dept. of Commerce

## Fellows

Walter Isard - Cornell University  
Edgar S. Dunn - University of Florida  
William H. Miernyk - RRI, West Virginia University, 1981  
Lowell D. Ashby - BEA, US Dept. of Commerce  
Rutledge Vining - University of Virginia  
F. Stuart Chapin, Jr. - University of North Carolina  
Charles L. Leven - Northwestern University, 1991  
William A. Schaffer - Georgia Institute of Technology, 1992  
Niles M. Hansen - University of Texas, Austin, 1993  
Brian Berry - University of Texas, Dallas, 1995  
James Hite - Clemson University  
John H. Cumberland - University of Maryland, 2000  
Thomas Johnson - University of Missouri, Columbia, 2002  
Mark S. Henry - Clemson University, 2004  
Hugh Knox - BEA, US Dept. of Commerce, 2006  
David Barkley - Clemson University, 2008  
Henry (Chip) Herzog - University of Tennessee, 2008  
John Kort - ERS, USDA, 2009  
Andrew M. Isserman - University of Illinois, Urbana -  
Champaign, 2010  
Judith I. Stallmann - University of Missouri, 2010  
Brian J. Cushing - West Virginia University, 2011  
Nancy White - Bucknell University, 2012  
Mark Partridge - Ohio State University, 2013  
Dan Rickman - Oklahoma State University, 2013  
James P. LeSage - Texas State University, 2014  
Randall W. Jackson - RRI, West Virginia University, 2015  
M. Rose Olfert, University of Saskatchewan, 2016



# Welcome to SRSA's 56<sup>th</sup> Conference

The Participant Index located on pages 37-38 shows when and in what session you are scheduled. Verify the timing and location of your papers and sessions.

The following provides a guide to the etiquette for all sessions:

- Each paper presentation generally is allotted twenty minutes.
- Discussants should prepare five minutes of remarks, allowing five minutes for questions and comments from other attendees.
- Session chairs and presenters should arrive ten minutes early for audio/visual preparation.
- It is the responsibility of the session chair to ensure a compatible laptop will be available in the session.
- Session chairs should preserve the order of the session to facilitate attendees who may be attempting to hear papers in concurrent sessions.
- Presenters and discussants should remain for the entire session.

## 56<sup>TH</sup> SRSA ANNUAL MEETING: PROGRAM OVERVIEW

Thursday, March 30

12:00pm-5:00pm

Registration: Noble Prefunction

3:30pm-5:30pm

Session 1A: State Forecasts – Noble B

Session 1B: Empirical Studies on the Effect of Targeted  
Economic Development Incentives –  
Noble C

6:30pm-9:00pm

SRSA Council Meeting: Noble A  
(By Invitation Only)

Friday, March 31

7:00am-5:00pm

Registration: Noble Prefunction

7:00am-8:00am

Continental Breakfast: Noble Prefunction

8:00am-10:00am

Session 2A: Issues Involving Income Distribution –  
Noble A

Session 2B: Regional Housing Market Issues I –  
Noble B

Session 2C: Entrepreneurial, Educational & Regional  
Economics – Noble C

Session 2D: Spatial Econometrics I - Poplar

10:00am-10:30am

Refreshment Break: Noble Prefunction

10:30am-12:00pm

Session 3A: Issues in Agricultural Economics –  
Noble A

Session 3B: Urban and Rural Economics Topics I –  
Noble B

Session 3C: Regional Economic Challenges – Noble C

Session 3D: Energy & Environmental Issues – Poplar

12:15pm-1:45pm

**Awards Luncheon: Salon A/B**

2:00pm-4:00pm

Session 4A: Targeted Economic Development  
Incentives, Economic Freedom, and  
Entrepreneurship – Noble A

Session 4B: Select Topics in Regional & Urban  
Economics II – Noble B

Session 4C: Urban and Rural Economics Topics II –  
Noble C

Session 4D: Regional Development & Related Issues –  
Poplar

5:30pm-6:30pm

Undergraduate Poster Presentations – Salon A/B

6:30pm-8:30pm

Reception: Salon A/B

**Saturday, April 1**

7:00am-12:00pm

Registration: Noble Prefunction

7:00am-8:00am

Continental Breakfast: Noble Prefunction

RRS Editor Breakfast: **Salon A**  
**(BY INVITATION ONLY)**

8:00am-10:00am

Session 5A: Regional Growth and Related Issues I –  
Noble A

Session 5B: Regional Growth and Related Issues II –  
Noble B

Session 5C: Regional Labor Markets – Noble C

Session 5D: Spatial Econometrics II - Poplar

10:00am-10:30am

Refreshment Break: Noble Prefunction

10:30am-12:00pm

Session 6A: Regional Applications of Econometrics –  
Noble A

Session 6B: Regional Factor Market-Related Topics –  
Noble B

Session 6C: Selected Regional Economic Issues –  
Noble C

Session 6D: Regional Entrepreneurship - Poplar

12:15pm-1:45pm

**Presidential Luncheon and SRSA Business Meeting:  
Salon A/B**

2:00pm

**56<sup>th</sup> SRSA Annual Meeting Ends**

## Thursday, March 30

**3:30 pm – 5:30 pm**

### **1A STATE FORECASTS**

**Room: Noble B**

**Chair: John Connaughton,**  
University of North Carolina-  
Charlotte

#### ***The North Carolina Economic Outlook***

**John Connaughton,** University of North  
Carolina-Charlotte

#### ***The South Carolina Economic Outlook for 2017***

**Joseph Von Nessen,** University of South  
Carolina-Columbia

#### ***The West Virginia Economic Outlook***

**Brian Lego,** West Virginia University

#### **Discussants:**

**Judith Stallmann,** University of Missouri

**1B EMPIRICAL STUDIES ON THE  
EFFECT OF TARGETED ECONOMIC  
DEVELOPMENT INCENTIVES**

**Room: Noble C**

**Chair: Daniel Sutter**, Troy  
University

***Economic Development Incentives and  
Income Inequality in US States***

**Jia Wang**, University of the South

**Cynthia Rogers**, University of Oklahoma

**Stephen Ellis**, University of Oklahoma

***Do Business Subsidies Lead to Increased  
Economic Activity? Evidence from Arkansas's  
Quick Action Closing Fund***

**Jacob Bundrick**, University of Central  
Arkansas

***Economic Development Incentives, Reported  
Job Creation and Local Employment***

**Paul F. Byrne**, Washburn University

***A New Estimate of State and Local Subsidies  
to Business in the United States***

**Kenneth Thomas**, University of Missouri –  
St. Louis

**Discussants:**

**Jacob Bundrick**, University of Central  
Arkansas

**Paul F. Byrne**, Washburn University

**Kenneth Thomas**, University of Missouri –  
St. Louis

**Jia Wang**, University of the South

**6:30 pm – 9:00 pm**

**SRSA COUNCIL MEETING**

**Room: Noble A**

**(By Invitation Only)**

## Friday, March 31

**7:00 am – 8:00 am**

**CONTINENTAL BREAKFAST**

**Room: Noble Prefunction**

**8:00 am – 10:00 am**

**2A INCOME DISTRIBUTION AND GROWTH**

**Room: Noble A**

**Chair: Randall Jackson, West Virginia University**

***Neighborhood Inequality Spillover Effects of Gentrification***

**Susane Leguizamon, Western Kentucky University**

**David Christafore, Weber State**

***IO-Snap Demonstration: IO State and National Analysis Program***

**Caleb Stair and Randall Jackson, West Virginia University**

***State Productivity and Growth***

**John Connaughton, University of North Carolina- Charlotte**

**Discussants:**

**John Connaughton, University of North Carolina- Charlotte**

**Susane Leguizamon, Western Kentucky University**

**Caleb Stair, West Virginia University**

## **2B REGIONAL HOUSING MARKET ISSUES I**

**Room: Noble B**

**Chair: Amanda Ross**, University of Alabama

### ***Neighborhood Identity and Housing Prices***

**Douglas Woodward**, University of South Carolina

**Joseph Von Nessen**, University of South Carolina

### ***Ethnic Groups and Bargaining***

**Amanda Ross**, University of Alabama

**Adam Nowak**, West Virginia University

### ***Inquiry: Housing Price Movements Across US Cities***

**Dan Gerlowski**, University of Baltimore

**Ting Zhang**, University of Baltimore

**Dong Chen**, University of Baltimore

### ***Flood Hazards Impact on Neighborhood House Prices***

**Lei Zhang**, North Dakota State University

**Tammy Leonard**, University of Dallas

### **Discussants:**

**Dan Gerlowski**, University of Baltimore

**Tammy Leonard**, University of Dallas

**Amanda Ross**, University of Alabama

**Douglas Woodward**, University of South Carolina



## **2C ENTREPRENEURSHIP, EDUCATIONAL, AND REGIONAL ECONOMICS**

**Room: Noble C**

**Chair: Steven Deller**, University of  
Wisconsin-Madison

### ***Corruption and Entrepreneurship: Evidence from US States***

**Can Chen**, Florida International University

**Shaoming Cheng**, Florida International  
University

### ***Student debt and occupational choice: Entrepreneurship and start-up employment***

**Wade Litt**, The Ohio State University

**Francesco Renna**, University of Akron

### ***Discrete Choice with Social Capital: An Application to Entrepreneurship by Age Group***

**Tessa Conroy**, University of Wisconsin-  
Madison

**Steven Deller**, University of Wisconsin-  
Madison

### ***Are foreign-born researchers more innovative? Self-selection, mismatch, and the production of knowledge among PhD recipients in the U.S.***

**Rodrigo Perez-Silva**, The Ohio State  
University

**Mark Partridge**, The Ohio State University

**William Foster**, Pontificia Universidad  
Catolica de Chile

### **Discussants:**

**Rodrigo Perez-Silva**, The Ohio State  
University

**Shaoming Cheng**, Florida International  
University

**Wade Litt**, The Ohio State University

**Steven Deller**, University of Wisconsin-  
Madison

## **2D SPATIAL ECONOMETRICS I**

**Room: Poplar**

**Chair: James Lesage**, Texas State University

### ***Spatial Effects of County Income Disparities and Growth in Pennsylvania, 1980-2015***

**Brian Sloboda**, University of Phoenix

**Yaya Sissoko**, Indiana University of Pennsylvania

### ***Naloxone access law and opioid overdose in the U.S.***

**Elham Erfanian**, West Virginia University

**Alan Collins**, West Virginia University

**Daniel Grossman**, West Virginia University

### ***A Matrix Exponential Spatial Panel Model With Heterogeneous Coefficients***

**James Lesage**, Texas State University

**Yao-Yo Chih**, Texas State University

### ***Spatial Durbin Mixture Models***

**Gary Cornwall**, University of Cincinnati

### **Discussants:**

**Yao-Yo Chih**, Texas State University

**Elham Erfanian**, West Virginia University

**Gary Cornwall**, University of Cincinnati

**Brian Sloboda**, University of Phoenix

---

**10:00 am – 10:30 am**

## **REFRESHMENT BREAK**

**Room: Noble Prefunction**

**10:30 am – 12:00 pm**

---

**3A ISSUES IN AGRICULTURAL ECONOMICS**

**Room: Noble A**

**Chair: Wayne Miller**, University of Arkansas

***The Impact of non-local buyers on farmland prices***

**Constant Tra**, University of Nevada, Las Vegas

**Charles Towe**, University of Connecticut

***Developing Standard Procedures for Contribution Analysis of Agriculture and Forestry***

**Wayne Miller**, University of Arkansas

**Jennie Popp**, University of Arkansas

**Leah English**, University of Arkansas

***Multiregional Analysis the Southeastern US Agricultural Water Footprint***

**Dayton Lambert**, University of Tennessee

**Di Sheng**, University of Tennessee

**Burt English**, University of Tennessee

**Jamey Menard**, University of Tennessee

**Discussants:**

**Dayton Lambert**, University of Tennessee

**Constant Tra**, University of Nevada, Las Vegas

**Wayne Miller**, University of Arkansas

## **3B URBAN AND RURAL ECONOMICS TOPICS I**

**Room: Noble B**

**Chair: Heather Stephens, West  
Virginia University**

### **The Economics of Rural America**

**Heather Stephens, West Virginia  
University**

**Mark Partridge, The Ohio State University**

**Stephen Goetz, Penn State University**

### ***Micros in the Middle: Educational Attainment, Occupations, and Economic Well-Being in the Micropolitan US***

**Bonnie Bounds, The Ohio State University**

### ***Mortality in Midlife for Non-Hispanic Whites in Central Appalachia, 1999-2014.***

**Frank O'Connor, Eastern Kentucky  
University**

### **Discussants:**

**Frank O'Connor, Eastern Kentucky  
University**

**Heather Stephens, West Virginia  
University**

**Bonnie Bounds, The Ohio State University**

### **3C REGIONAL ECONOMIC CHALLENGES**

**Room: Noble C**

**Chair: Melody Muldrow**, University  
of Arkansas at Little Rock

***Integrating People and Place: Quantitative  
and Qualitative Approaches to Poverty  
Analysis in Arkansas***

**Melody Muldrow**, University of Arkansas  
at Little Rock

**Malcolm Glover**, Jack Welch Management  
Institute

***Spatial Analysis of Poverty in South Carolina***

**Willis Lewis**, Winthrop University

**Christopher Johnson**, University of North  
Florida

***Migrants and Boomtowns: Micro Evidence  
from the U.S. Shale Boom***

**Isha Rajbhandari**, The Ohio State  
University

**Alessandra Faggian**, The Ohio State  
University

**Mark Partridge**, The Ohio State  
University

**Discussants:**

**Isha Rajbhandari**, The Ohio State  
University

**Melody Muldrow**, University of Arkansas  
at Little Rock

**Willis Lewis**, Winthrop University

### **3D ENERGY AND ENVIRONMENTAL ISSUES**

**Room: Poplar**

**Chair: Peter Schaeffer**, West Virginia University

***Economic impacts of cancelled recreational trips to Northwest Florida after the Deepwater Horizon oil spill***

**Christa Court**, University of Florida

**Alan Hodges**, University of Florida

**Rodney Clouser**, University of Florida

**Sherry Larkin**, University of Florida

***Local employment effects of an oil price shock***

**Mouhcine Guettabi**, University of Alaska Anchorage

***Labor Force of the Appalachian Coal Industry***

**Peter Schaeffer**, West Virginia University

**Matthew Murray**, University of Tennessee-Knoxville

**Discussants:**

**Peter Schaeffer**, West Virginia University

**Christa Court**, University of Florida

**Mouhcine Guettabi**, University of Alaska Anchorage

---

**12:15 pm – 1:45 pm**

### **AWARDS LUNCHEON**

**Room: Salon A/B**

### **SRSA Fellows Address**

***Searching for Isard's Regional Essence: A Whole Greater than the Sum of its Parts***

**Douglas Woodward**, University of South Carolina

**2:00 pm – 4:00 pm**

---

**4A TARGETED ECONOMIC  
DEVELOPMENT INCENTIVES,  
ECONOMICS FREEDOM, AND  
ENTREPRENEURSHIP**

**Room: Noble A**

**Chair: Matthew Mitchell, George  
Mason University**

***Using Economic Incentives to Offset State-  
Level Deficiencies***

**Pete Calcagno, College of Charleston**

**Frank Hefner, College of Charleston**

***Is There a Tradeoff Between Economic  
Development Incentives and Economic  
Freedom?***

**John Dove, Troy University**

**Daniel Sutter, Troy University**

***Targeted Business Incentives and Firm  
Deaths***

**Dean Stansel, Southern Methodist  
University**

**Meg Patrick Tuszynski, Southern  
Methodist University**

***Untargeted Incentives and  
Entrepreneurship: An Analysis of Local Fiscal  
Policies and Small Businesses in Florida***

**David Guo, Florida International University**

**Shaoming Cheng, Florida International  
University**

**Discussants:**

**Shaoming Cheng, Florida International  
University**

**Frank Hefner, College of Charleston**

**John Dove, Troy University**

**Meg Patrick Tuszynski, Southern  
Methodist University**

**4B SELECT TOPICS IN  
REGIONAL/URBAN ECONOMICS II**  
**Room: Noble B**  
**Chair: William Schaffer, Georgia  
Institute of Technology**

***Developing County Level Input-Output  
Models***

**William Schaffer, Georgia Institute of  
Technology**

***Does Skill Aggregation Across Cities Diverge  
or Converge? Evidence from the Mariel  
Boatlift***

**Seung-Hun Chung, The Ohio State  
University**

***Naturalization and the Productivity of  
Foreign-Born Doctorates***

**Daniel Crown, The Ohio State University**

***Knowledge spillovers and wage inequality.  
The side effect of the concentration of highly  
educated workers in U.S. cities***

**Rodrigo Perez-Silva, The Ohio State  
University**

**Discussants:**

**Seung-Hun Chung, The Ohio State  
University**

**Daniel Crown, The Ohio State University**

**Rodrigo Perez-Silva, The Ohio State  
University**

**John Winters, Oklahoma State University**



## **4C URBAN AND RURAL ECONOMIC TOPICS II**

**Room: Noble C**

**Chair: Mark Burkey**, North Carolina A&T State University

### ***Geographic Accessibility to Hospitals in the United States: Rurality and Insurance Coverage***

**Mark Burkey**, North Carolina A&T State University

**Mariama Sidibe**, North Carolina A&T State University

### ***Unbearable Consequences: Bear Hunting and The Spillovers of Bear Property Damages in West Virginia***

**Caleb Stair**, West Virginia University

### ***Ohio's Wood Industry Cluster: Identifying Value-Added Opportunities in the Appalachian Region***

**Gilbert Michaud**, Ohio University

**G. Jason Jolley**, Ohio University

### ***Assessment of the Housing Capital Stock in Bogota: An Application of the Hedonic Valuation Methodology***

**William Orlando Prieto Bustos**,  
Universidad Católica de Columbia

**Johanna Elizabeth Manrique Hernández**,  
Universidad Nacional de Colombia

### **Discussants:**

**Johanna Elizabeth Manrique Hernández**,  
Universidad Nacional de Colombia

**Mark Burkey**, North Carolina A&T State University

**Caleb Stair**, West Virginia University

**Gilbert Michaud**, Ohio University

## **4D REGIONAL DEVELOPMENT AND RELATED ISSUES**

**Room: Poplar**

**Chair: Santiago Pinto**, Federal Reserve Bank of Richmond

### ***The Impacts of Transportation Investments in Turkey: at the Spatial Computable General Equilibrium Model framework***

**Metin Piskin**, University of Illinois at Urbana-Champaign

### ***A Panel Granger Causality Test of Total Factor Productivity, ICT Penetration, and Electricity Consumption: Evidence from Africa***

**Chali Nondo**, Massachusetts College of Liberal Arts

### ***The Impact of Federal Environmental Regulations of Local Economic Growth***

**Brianne Zimmerman**, West Virginia University

**Heather Stephens**, West Virginia University

### ***The Urban Transport System Choice in a Duocentric City Model***

**Santiago Pinto**, Federal Reserve Bank of Richmond

### **Discussants:**

**Chali Nondo**, Massachusetts College of Liberal Arts

**Santiago Pinto**, Federal Reserve Bank of Richmond

**Metin Piskin**, University of Illinois at Urbana-Champaign

**Brianne Zimmerman**, West Virginia University

**5:30 pm – 6:30 pm**

---

**UNDERGRADUATE POSTER  
PRESENTATIONS**

**Room: Salon A/B**

**Chair: Heather Stephens, West  
Virginia University**

***Impact of the Great Recession on Parish  
Governments in Louisiana***

**Katherine Burley, Louisiana State  
University**

***Exitability and Economic Freedom: Evidence  
from the United States***

**Jennifer Mangano, West Virginia  
University**

***Immigration and Baumolian  
Entrepreneurship***

**Josh Bedi, Mississippi State University**

***An Analysis of the Changes in Income  
Inequality across Brazilian Municipalities  
from 2000 to 2010***

**Victoria Belcher, University of South  
Carolina**

***Identifying Northeastern Regional Rural  
Needs and Programs***

**Stella Barrat, West Virginia University**

***Mallard Fox Creek Industrial Park and  
Cummings Research Park: Investigating  
Employment and Income Impacts***

**Jared Grogan and Chris Brookshaw,  
University of Alabama in Huntsville**

**6:30 pm – 8:30 pm**

---

**SRSA RECEPTION**

**Room: Salon A/B**

## **Saturday, April 1**

**7:00 am – 8:00 am**

---

**CONTINENTAL BREAKFAST**

**Room: Noble Prefunction**

**RRS EDITOR BREAKFAST**

**Room: Salon A**

**(By Invitation Only)**

**8:00 am – 10:00 am**

---

**5A REGIONAL GROWTH AND RELATED ISSUES I**

**Room: Noble A**

**Chair: David Hughes**, University of Tennessee

***Creative Capital, Information and Communication Technologies, and Economic Growth in Smart Cities***

**Amit Batabyal**, Rochester Institute of Technology

**Peter Nijkamp**, Tinbergen Institute

***Self-employment effects on regional growth: A bigger bang for a buck?***

**Alexandra Tsvetkova**, The Ohio State University

**Mark Partridge**, The Ohio State University

**Michael Betz**, The Ohio State University

***Regional Craft Beer Industry Growth: Hurt, Help or Doesn't Matter for Regional Wine Industry***

**David Hughes**, University of Tennessee

**Dayton Lambert**, University of Tennessee

***Peer Group Comparisons of the Effect of High School Civic Engagement on Adult Political Participation***

**Olugbenga Ajilore**, University of Toledo

**Discussants:**

**Olugbenga Ajilore**, University of Toledo

**Amit Batabyal**, Rochester Institute of Technology

**Alexandra Tsvetkova**, The Ohio State University

**David Hughes**, University of Tennessee

## **5B REGIONAL GROWTH AND RELATED ISSUES II**

**Room: Noble B**

**Chair: Jing Chen**, West Virginia University

***Geographical Scale, Industrial Diversity and Regional Economic Stability***

**Jing Chen**, West Virginia University

***Evolution of Industrial Hubs and Authorities in US***

**Shirshir Shakya**, West Virginia University

***How Centralized is U.S. Metro Employment?***

**Jason Brown**, Federal Reserve Bank of Kansas City

**Maeve Maloney**, Federal Reserve Bank of Kansas City

**Jordan Rappaport**, Federal Reserve Bank of Kansas City

**Aaron Smalter Hall**, Federal Reserve Bank of Kansas City

**Discussants:**

**Jason Brown**, Federal Reserve Bank of Kansas City

**Jing Chen**, West Virginia University

**Shirshir Shakya**, West Virginia University

## **5C REGIONAL LABOR MARKETS**

**Room: Noble C**

**Chair: John Winters**, Oklahoma State University

***The Regional Effects of International Migration on Domestic Accumulation of Human Capital***

**Marian Manic**, Whitman College

***Locational Differences in Labor Supply Decisions of White and Minority Women***

**Natalia Kolesnikova**, University of Mississippi

***The Impact of Local Labor Market Conditions on Intergenerational Mobility***

**Bo Feng**, The Ohio State University

**Mark Partridge**, The Ohio State University

***Do Foreigners Crowd Natives out of STEM Degrees and Occupations? Evidence from the U.S. Immigration Act of 1990***

**Tyler Ransom**, Duke University

**John Winters**, Oklahoma State University

**Discussants:**

**John Winters**, Oklahoma State University

**Marian Manic**, Whitman College

**Natalia Kolesnikova**, University of Mississippi

**Bo Feng**, The Ohio State University

## **5D SPATIAL ECONOMETRICS II**

**Room: Poplar**

**Chair: James Lesage**, Texas State University

### ***Partial privatization in asymmetric multi-market competition***

**Tohru Naito**, Doshisha University

**Akio Kawasaki**, Kagoshima University

### ***Revisiting Roback's (1982) Spatial Hedonic Equilibrium Model: A County-level Analysis with an Explicit Spatial Approach***

**Jinhyoung Kim**, University of Missouri

**Thomas Johnson**, University of Missouri

**John Pender**, Economic Research Service, USDA

### ***A heterogeneous coefficient approach to the knowledge production function***

**James Lesage**, Texas State University

**Corinne Autant-Bernard**, Université Jean Monnet

### ***Poverty Changes and Forced Migration: The Case of Colombia***

**Juan Tomas Sayago Gomez**, West Virginia University

### **Discussants:**

**Juan Tomas Sayago Gomez**, West Virginia University

**Tohru Naito**, Doshisha University

**Jinhyoung Kim**, University of Missouri

**James Lesage**, Texas State University



**10:00 am – 10:30 pm**

---

**REFRESHMENT BREAK**

**Room: Noble Prefunction**

**10:30 pm – 12:00 pm**

---

**6A REGIONAL APPLICATIONS OF  
ECONOMETRICS**

**Room: Noble A**

**Chair: Tim Komarek**, Old Dominion  
University

***Recurrent Flooding, Information  
Asymmetries and Real Estate Prices:  
Evidence from Hampton Roads, VA***

**Timothy Komarek**, Old Dominion  
University

**Larry Filer**, Old Dominion University

**Timothy Hodge**, Oakland University

**Jon Loftis**, Virginia Institute of Marine  
Sciences

***GIS Enabled Decision Support System for  
Resource Allocation for Flood Disaster  
Management***

**Ather Ashraf**, Planning and  
Development Department, Punjab, Pakistan  
**Hira Sajid**, Punjab University

***Modeling Network interdependencies of  
regional economies using spatial  
econometric techniques***

**Peter Jarosi**, West Virginia University

**Discussants:**

**Ather Ashraf**, Planning and  
Development Department, Punjab, Pakistan

**Peter Jarosi**, West Virginia University

**Timothy Komarek**, Old Dominion  
University

## **6B REGIONAL FACTOR MARKET-RELATED TOPICS**

**Room: Noble B**

**Chair: Jason Brown**, Federal Reserve Bank of Kansas City

### ***Response of Consumer Debt to Income Shocks: The Case of Energy Development Booms and Busts***

**Jason Brown**, Federal Reserve Bank of Kansas City

### ***Firm Survival in Rural America: Is Access to Capital a Barrier?***

**Sarah A. Low**, Economic Research Service, USDA

**Anil Rupasingha**, Economic Research Service, USDA

**Daniel Crown**, The Ohio State University

### ***Amenity and Geography of Innovation: Evidence from Chinese Cities***

**Min Zhang**, Zhejiang University

**Mark Partridge**, The Ohio State University

**Huasheng Song**, Zhejiang University

**Xiaochen Zhang**, The Ohio State University

### **Discussants:**

**Min Zhang**, Zhejiang University

**Jason Brown**, Federal Reserve Bank of Kansas City

**Daniel Crown**, The Ohio State University

## **6C    SELECTED REGIONAL ECONOMIC ISSUES**

**Room: Noble C**

**Chair: Jinhwan Oh**, Ewha Woman's University

***Concentration or Congestion? Aid Fragmentation of Emerging Donors, with a Reference to Korean Education Aid to Cambodia***

**Jinhwan Oh**, Ewha Woman's University

***On Research and Development in a Model of Schumpeterian Economic Growth in a Creative Region***

**Amit Batabyal**, Rochester Institute of Technology

**Seung Yoo**, Sookmyung Women's University

***The Local-Organic Premium for Agricultural Produce: A Northern New England Case Study***

**Samantha Werner**, University of New Hampshire

**Scott Lemos**, University of New Hampshire

**John Halstead**, University of New Hampshire

**Ju-Chin Haung**, University of New Hampshire

**Discussants:**

**Samantha Werner**, University of New Hampshire

**Jinhwan Oh**, Ewha Woman's University

**Amit Batabyal**, Rochester Institute of Technology

## **6D REGIONAL ENTREPRENEURSHIP**

**Room: Poplar**

**Chair: John Lombard**, Old Dominion University

***A Simultaneous Model of Youth Entrepreneurship and Financial Inclusion Across Developing Countries***

**Angela Lyons**, University of Illinois at Urbana-Champaign

**Sergio Contreras**, University of Illinois at Urbana-Champaign

***Poverty, Income Distribution and Small Business Activity: How do Women Entrepreneurs Factor into the Discussion?***

**Steven Deller**, University of Wisconsin-Madison

**Terra Conroy**, University of Wisconsin-Madison

***The Impact of Labor Regulations on Entrepreneurship: Causal Evidence from the United States***

**Sriparna Ghosh**, West Virginia University

**Punarjit Roychowdhury**, Southern Methodist University

**Discussants:**

**Sriparna Ghosh**, West Virginia University

**Sergio Contreras**, University of Illinois at Urbana-Champaign

**Steven Deller**, University of Wisconsin-Madison

**12:15 pm – 1:45 pm**

---

**PRESIDENTIAL LUNCHEON AND SRSA  
BUSINESS MEETING**

**Room: Salon A/B**

**2:00 pm**

---

**END OF SRSA CONFERENCE**

## **Notes**

## Participants Index

Participant		Email Address	Session
Ajilore	Olugbenja	gbenga.ajilore@utoledo.edu	5A
Ashraf	Ather	atherashraf@gmail.com	6A
Barrat	Stella	sdbarrat@mix.wvu.edu	Poster
Batabyal	Amitrajeet	aabgsh@rit.edu	5A, 6C
Bedi	Josh	Jkb200@msstate.edu	Poster
Belcher	Victoria	vbelcher@email.sc.edu	Poster
Bounds	Bonnie	bebounds@gmail.com	3B
Brookshaw	Chris	csb0012@uah.edu	Poster
Brown	Jason	jason.brown@kc.frb.org	5B, 6B
Bundrick	Jacob	jbundrick@uca.edu	1B
Burkey	Mark L	burkeym@gmail.com	4C
Burley	Katherine	kburle6@lsu.edu	Poster
Byrne	Paul		1B
Cebula	Richard	rcebula@ju.edu	
Chen	Jing	chenjing412@gmail.com	5B
Cheng	Shaoming	scheng@flu.edu	2C, 4A
Chih	Yao-Yu	y_c66@txstate.edu	2D
Christafore	David	david.christafore@gmail.com	2A
Chung	Seung-hun	chung.615@osu.edu	4B
Connaughton	John	jec@uncc.edu	1A, 2A
Contreras	Sergio	scontre1@illinois.edu	6D
Cornwall	Gary	cornwagi@mail.uc.edu	2D
Court	Christa	ccourt@ufl.edu	3D
Crown	Daniel	crown.15@osu.edu	4B, 6B
Deller	Steven	scdeller@wisc.edu	2C, 6D
Dove	John	jadove@troy.edu	4A
Erfanian	Zohreh	el_erfanian@yahoo.com	2D
Feng	Bo	albus.feng@hotmail.com	5C
Gerlowski	Dan	dangerlowski@verizon.net	2B
Ghosh	Sriparna	srghosh@mix.wvu.edu	6D
Grogan	Jared	Jtg0010@uah.edu	Poster
Guettabi	Mouhcine	mguettabi@alaska.edu	3D
Hefner	Frank	hefnerf@cofc.edu	4A
Hughes	David	dhughe2@gmail.com	5A
Jackson	Randall	Randall.Jackson@mail.wvu.edu	2A
Járosi	Péter	peter.jarosi@mail.wvu.edu	6A
Kim	Jinhyoung	jin.h.kim119@gmail.com	5D
Kolesnikova	Natalia	natalia@olemiss.edu	5C
Komarek	Tim	tim.komarek@gmail.com	6A
Lambert	Dayton	dlamber1@utk.edu	3A, 5A
Lego	Brian	Brian.Lego@mail.wvu.edu	1A
Leguizamon	Susane	susane_d2100@yahoo.com	2A
Leonard	Tammy	tleonard@udallas.edu	2B
Lesage	James	james.lesage@txstate.edu	2D, 5D
Lewis	Willis	lewisw@winthrop.edu	3C
Litt	Wade	wadehlitt@gmail.com	2C
Lombard	John	jlombard@odu.edu	6D
Low	Sarah	slow@ers.usda.gov	6B
Mangano	Jennifer	jrmangano@mix.wvu.edu	Poster
Manic	Marian	manicm@whitman.edu	5C

Manrique H	Johanna	jemanriqueh@gmail.com	4C
Michaud	Gilbert	michaudg@ohio.edu	4C
Miller	Wayne P	wmiller@uaex.edu	3A
Mitchell	Matthew	mattdmitchell@gmail.com	4A
Muldrow	Melody	mlmuldrow@ualr.edu	3C
Naito	Tohru	tohrunaito@gmail.com	5D
Nondo	Chali	nondo.chali@gmail.com	4D
O'Connor	James F	frankoc@bellsouth.net	3B
Oh	Jinhwan	joh@ewha.ac.kr	6C
Perez	Rodrigo	rodrigoperezs@gmail.com	2C, 4B
Pinto	Santiago	santiago.pinto@rich.frb.org	4D
Piskin	Metin	piskin@illinois.edu	4D
Rajbhandari	Isha	isha.3you@gmail.com	3C
Rogers	Cynthia	crogers@ou.edu	1B
Ross	Amanda	aross@cba.ua.edu	2B
Sayago Gomez	Juan	juantomas.sayago@gmail.com	5D
Schaeffer	Peter	Peter.Schaeffer@mail.wvu.edu	3D
Schaffer	William	william.schaffer@econ.gatech.edu	4B
Shakya	Shishir	ss0066@mix.wvu.edu	5B
Sloboda	Brian	bsloboda@email.uophx.edu	2D
Stair	Caleb	caleb.a.stair@gmail.com	2A, 4C
Stallmann	Judith	stallmannj@missouri.edu	1A
Stephens	Heather	heather.stephens@mail.wvu.edu	3B, 4D
Sutter	Daniel	dansutter64@gmail.com	1B, 4A
Thomas	Kenneth		1B
Tra	Constant	constant.tra@unlv.edu	3A
Tsvetkova	Alexandra	tsvetkova.alexandra@gmail.com	5A
Tuszynski	Meg	megpatrick11@gmail.com	4A
Von Nessen	Joseph	joey.vonnessen@moore.sc.edu	1A, 2B
Wang	Jia	wangjia1019@gmail.com	1B
Werner	Samantha	slq66@wildcats.unh.edu	6C
Winters	John	jvwinte@okstate.edu	4B, 5C
Woodward	Douglas	douglasp.woodward@gmail.com	2B
Zhang	Min	minzhangzju@hotmail.com	6B
Zimmerman	Brianne	brzimmerman0@gmail.com	4D





**Public Policy Analysis:** The BBER has a long history of research and analysis of public finance and public policy issues in West Virginia. Recent projects include studies on cigarette excise taxation, personal income tax policy, and Right to Work policy.

**Industry Studies:** BBER researchers routinely study particular industries for industry and government groups. Our “Coal Production in West Virginia: 2015-2035” has been cited around 100 times by state and national media outlets.

**Legislative Testimony:** BBER economists formally testify before the West Virginia Legislature on a regular basis. In 2014 a BBER economist testified before the U.S. House of Representatives, Subcommittee on Contracting and Workforce.

**Health Policy:** Health policy is of vital interest to our state. For instance, we recently examined the possibility of consolidating the state’s public health departments in terms of potential to lower system-wide expenditures and to generate additional revenue.

**Energy Policy:** West Virginia being an energy state, the BBER regularly studies energy policy issues. Recently we published “Government Incentives to Promote Demand for West Virginia Coal.”

[www.be.wvu.edu/bber](http://www.be.wvu.edu/bber)



---

[rri.wvu.edu](http://rri.wvu.edu)

886 Chestnut Ridge Road, PO Box 6825

Morgantown, WV 26506-6825

Tel: 304-293-2897

West Virginia University is an Equal Opportunity  
Affirmative Action Institution.

---



## THE COUNCIL FOR COMMUNITY AND ECONOMIC RESEARCH

**Mission.** Founded in 1961, the Council for Community and Economic Research (C2ER) is a membership organization that promotes excellence in community and economic research by working to improve data availability, enhance data quality, and foster learning about regional economic analytic methods. C2ER accomplishes this mission by:

- Conducting training, advocacy, and research
- Delivering innovative products and services for researchers
- Developing professional networks

**Members.** C2ER's 700 members span a broad range of specialty skills and collectively touch all aspects of state and local community and economic development in the U.S. They include research professionals from:

- |                             |                                |
|-----------------------------|--------------------------------|
| • Chambers of Commerce      | • Utility Companies            |
| • Economic Development Org. | • Workforce Development Boards |
| • Government Agencies       | • Community Development Org.   |
| • Universities              | • Consultants & Data Providers |

**Products & Services.** The Council for Community and Economic Research (C2ER) produces several proprietary products and provides a variety of services to members and non-members.

**Cost of Living Index:** The quarterly Cost of Living Index compares cost of living differences between urban areas weighted by different categories of consumer expenditures for mid-management households.

**State Business Incentives Database:** The State Business Incentives Database is a searchable database of incentive programs used by states for strategic business attraction. It includes more than 1,900 incentive programs organized according to program category, program type, geographic focus, and business need.

**State Economic Development Expenditures Database:** Collected by aggregating state budget data, the Expenditures Database assesses total resources available for economic development activity across more than 15 functional areas and multiple funding sources using consistent funding categorizations.

**Training / Webinars:** In cooperation with the LMI Institute, C2ER offers a comprehensive training program for economic development and labor market information analysts and develops and delivers customized training.

**Certification:** C2ER's primary professional certification, Certified Community Researcher (CCR), is the industry standard for recognizing excellence in community and economic research. CCRs undertake a rigorous course of training and evaluation to earn this distinction.

**Weekly Update:** The C2ER/LMI Institute Weekly Update is an informational "one-stop" for economic development and labor market researchers.

**Annual Conference:** The C2ER Annual Conference is the primary national conference for economic development, and is held in conjunction with the LMI Annual Forum.

**Technical Assistance:** C2ER aids federal and state agencies by conducting surveys, providing facilitation, and implementing one-on-one skill development in using statistics in data-driven decision-making.

PO Box 100127, Arlington, VA 22201 - [www.c2er.org](http://www.c2er.org)



## Economic Research Service

### ERS Research and Information Products

#### Publications

#### Charts

#### Mapping

The USDA's Economic Research Service produces high quality, objective research and analysis on issues affecting food, agriculture, rural America, and the environment. ERS provides free access to its research publications, charts, mapping tools, data sets **and much more** online at [www.ers.usda.gov](http://www.ers.usda.gov), here is a sampling:

### PUBLICATIONS

#### Research Reports

In-depth analysis of the issues affecting food, agriculture, rural America, and the environment.  
[www.ers.usda.gov/publications](http://www.ers.usda.gov/publications)

#### Outlook Reports

Market analysis and projections of U.S. and world agricultural production, consumption, and trade  
[www.ers.usda.gov/publications/outlook](http://www.ers.usda.gov/publications/outlook)

#### Monthly Magazine – *Amber Waves*

E-zine – [www.ers.usda.gov/amber-waves](http://www.ers.usda.gov/amber-waves)

Tablet app – Get “*Amber Waves*” delivered to your tablet’s mobile bookshelf from iTunes or Google Play

### CHARTS

#### Ag and Food Statistics: Charting the Essentials

A collection of charts and maps with key agricultural and food information. [www.ers.usda.gov/essentials](http://www.ers.usda.gov/essentials)

#### Charts of Note

A daily chart, online and by email delivery  
[www.ers.usda.gov/ChartsofNote](http://www.ers.usda.gov/ChartsofNote)

### MAPS

#### Atlas of Rural and Small Town America

Statistics on people, jobs, agriculture, and county types.  
[www.ers.usda.gov/data-products/atlas-of-rural-and-small-town-america.aspx](http://www.ers.usda.gov/data-products/atlas-of-rural-and-small-town-america.aspx)

#### Food Access Research Atlas

Spatial overview of food access indicators for low-income and other neighborhoods by U.S. Census tract.  
[www.ers.usda.gov/data-products/food-access-research-atlas.aspx](http://www.ers.usda.gov/data-products/food-access-research-atlas.aspx)

#### Food Environment Atlas

Compares U.S. counties’ food environment (mix of factors that influence food choices, diet quality, and general fitness of residents). [www.ers.usda.gov/foodatlas](http://www.ers.usda.gov/foodatlas)

**Trusted and respected resource for economic modeling and analyses for clients in academia, industry, and government.**



*Dr. Alan Hodges, Director; Dr. Christa Court, Assistant Director;  
Dr. Mohammad Rahmani, Research Associate*

### **Over 25 years experience**

- » **analyzing the economic impact** of industry activity, commodity production, government regulations or policies, new technologies, or natural disasters
- » **evaluating economic linkages** among industries, institutions, and households
- » **forecasting effects** of market or policy changes

### **Our Promise**

To apply academically rigorous methodologies to our work and to effectively communicate results in a manner that is accessible to a wide variety of audiences.

### **Our Services**

- » regional economic modeling
- » economic impact analysis
- » economic contribution studies

**UF | IFAS** | **ECONOMIC IMPACT ANALYSIS PROGRAM**  
UNIVERSITY of FLORIDA

☎ 352-294-7675



Jacksonville University was founded in 1934, and enrolls more than 4,000 students in over 70 programs including Engineering, Cybersecurity, Music Business, Kinesiology, Business Analytics, Sustainability, and more. It is the oldest and largest private masters university in the North Florida and South Georgia region. The campus, known for its beauty, is located on the eastern shore of the St. Johns River within minutes of downtown Jacksonville. The University campus is all located within a rolling 240-acre riverfront site. Our student body hails from across the country and the world, with about half coming from outside of Florida.





# IMPLAN

NOW FEATURING  
**PANEL DATA**

**Statistical analysis with  
Implan data will be more  
accurate due to these  
enhancements:**

- Use of revised raw data
- Wage and salary, and proprietor employment type split
- Consistent estimation methodologies
- Consistent and more detailed sectoring scheme

**IMPLAN.COM**

